



Suzuki DR-Z 400 S (2002 - 2004)

Slip-on Exhaust System

Akrapovic Slip-on Exhaust System

for the Suzuki DR-Z 400 S (2002 - 2004)

The Suzuki DR series includes two versions, the popular dual-purpose model DR-Z 400S and the more stripped-down DR-Z 400E. Perhaps a bit overshadowed by more heavily-promoted competing models, this series with its slightly smaller displacement can still provide excellent competition to the larger-displacement bikes in the 450 cc class.

GOAL

After a long break, one of Suzuki's off-road models finds itself under the scrutiny of the Akrapovic R&D team. We have developed a SLIP-ON partial exhaust system and an EVOLUTION complete exhaust system for the DR-Z 400S. These systems cover the entire spectrum of riders; both those who do not wish to make any major modification of their exhaust systems and those who desire a complete replacement. Here we present the Akrapovic SLIP-ON system.

ABOUT AKRAPOVIC SLIP-ON SYSTEMS:

The Akrapovic SLIP-ON line is intended as an initial stage of exhaust system tuning. Its design is appropriate to this function. It replaces the back part of the stock exhaust system with a very simple installation procedure.

The Akrapovic SLIP-ON system is constructed from two main parts: a muffler and a link pipe. In the case of the Suzuki the muffler and link pipe are welded together to form a single piece. The link pipe is made of high-quality stainless steel, as is the front rosette on the muffler to which it is welded. We should mention that the link pipe is of conical shape, which matches the front part of the stock exhaust and contributes appropriately to improved engine characteristics. The connection to the stock exhaust is made with a free-floating joint held together with metal regulating clamps.

The muffler for this system is the standard Akrapovic Offroad design. Except for the front rosette it is made entirely of titanium, including the outer sleeve. The muffler is held in place through all the shocks and stresses of off-road riding using an Akrapovic dual carbon-fiber clamp.

Measurements of the SLIP-ON system for the Suzuki DR-Z 400 S:

power:

its excellent match-up with the stock header tube can be seen from the power curve. The Akrapovic curve follows the stock curve faithfully, with of course a welcome increase. With our system the engine is allowed to breathe; it shows a greater willingness to rev and faster power delivery on command. Even in the overrev range at 9200 rpm there is a 2 HP increase on the stock power.

torque:

an increase in torque is particularly welcome on a smaller-displacement bike like the DR-Z 400. By installing the Akrapovic SLIP-ON system your Suzuki will gain much-needed torque, especially in the area from 3000 to 4000 rpm and near 5000 rpm.

The main purpose of the Akrapovic SLIP-ON is well known. It is to provide an aesthetic improvement to the lines of the bike, while at the same time providing a performance increase appropriate to first-phase tuning. The SLIP-ON system will also definitely change the sound of the Suzuki's engine. And since off-roaders want to save as much weight as possible, the Akrapovic SLIP-ON system is clearly designed with this in mind, offering a weight savings of 1.52 kg. All of this comes at an affordable price, since one of the main arguments for developing this system was as a replacement in the case of damage.

	stock	AKRAPOVIC		difference	
		S.S.	titanium	stock - S.S.	stock - titanium
weight comparison	4.20 kg	2.68 kg		1.52 kg	
max. rear wheel power	32.8 HP / 7500 RPM	33.3 HP / 7500 RPM		2 HP / 9200 RPM*	
noise measurement	88 db / 4500 RPM	96 db / 4500 RPM		8 db / 4500 RPM	
periodic service possibilities without taking off A.E.S.	oil		oil filter		
	YES		YES		
legal for street use	NO				

*MAXIMUM MEASURED POWER DIFFERENCE

Technical specifications of Akrapovic exhaust systems and related products subject to change without notice.

Product code: S-S4SO1-MT

Akrapovic Slip-on Exhaust System

for the Suzuki DR-Z 400 S (2002 - 2004)



CARBON-FIBER
MUFFLER CLAMP

Off-Road
Program

Product code: S-S4S01-MT

Akrapovic Slip-on Exhaust System

for the Suzuki DR-Z 400 S (2002 - 2004)



Akrapovic Exhaust System Technology copyright 2003, all rights reserved

Off-Road
Program

Product code: S-S4S01-MT

Akrapovic Slip-on Exhaust System for the Suzuki DR-Z 400 S (2002 - 2004)



Akrapovic Exhaust System Technology copyright 2003, all rights reserved

Off-Road
Program

Product code: S-S4S01-MT

Akrapovic Slip-on Exhaust System

for the Suzuki DR-Z 400 S (2002 - 2004)

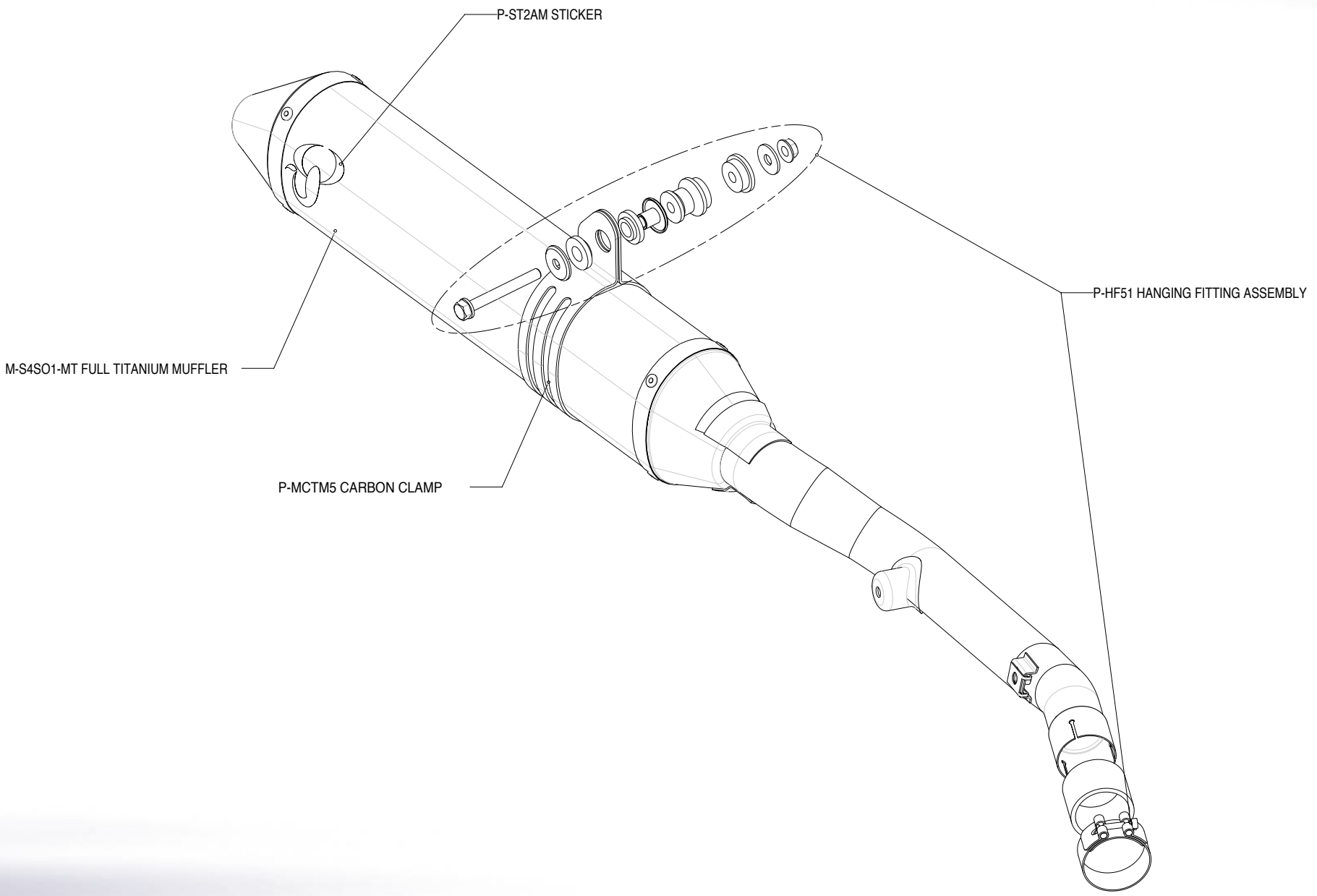

Akrapovic Exhaust System Technology copyright 2003, all rights reserved

Off-Road Program

Product code: S-S4SO1-MT



Akrapovic Slip-on Exhaust System

for the Suzuki DR-Z 400 S (2002 - 2004)

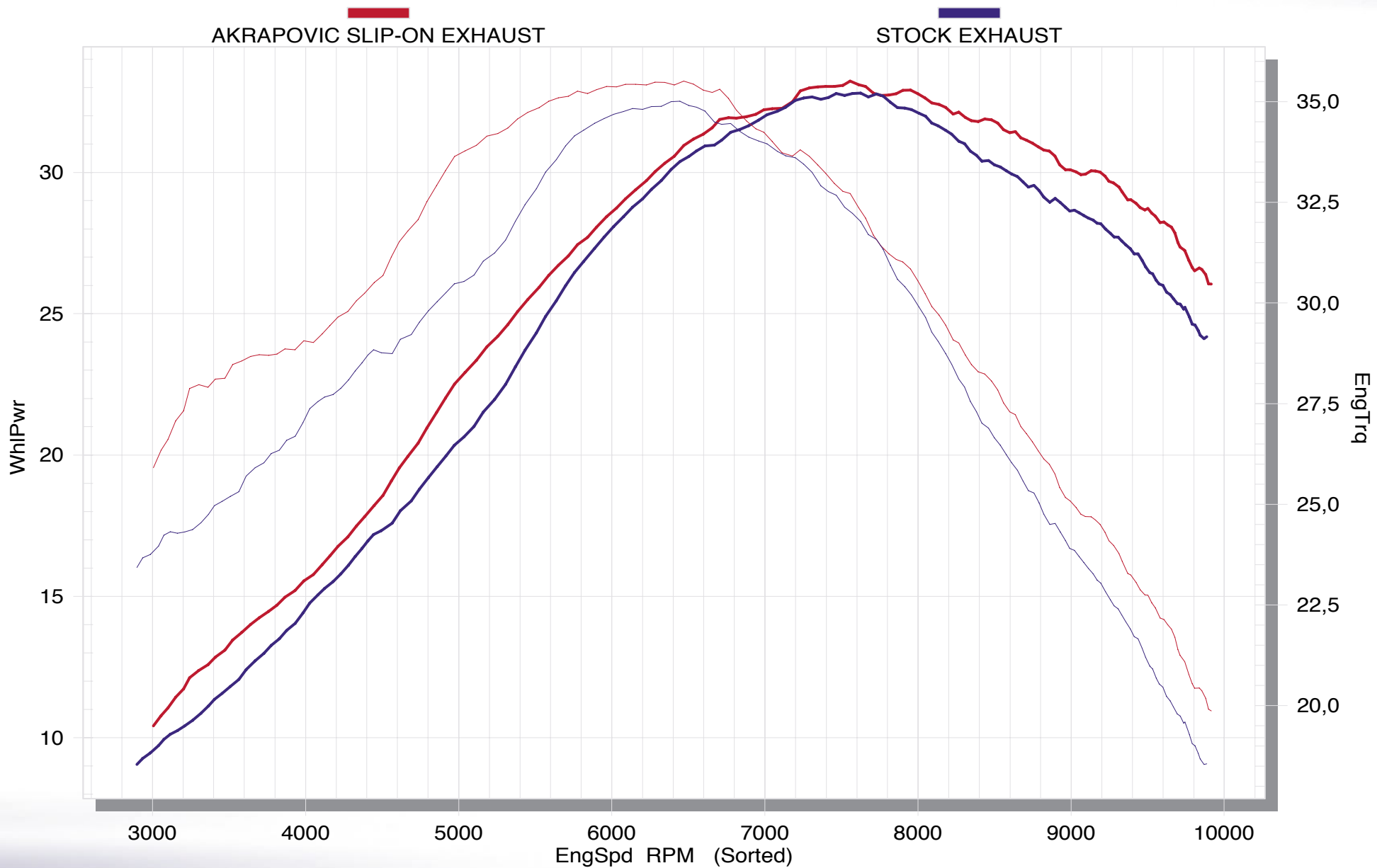

Akrapovic Exhaust System Technology copyright 2003, all rights reserved

Off-Road Program

Product code: S-S4SO1-MT

